

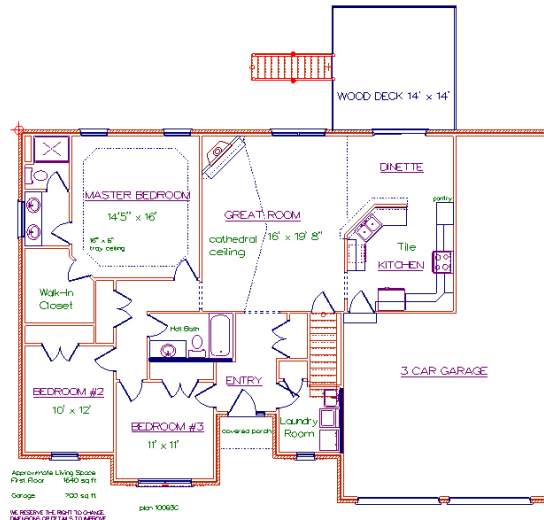

1902 Pleasant Hill Dr.  
Pleasant Hill Lot 35  
Florence, KY



- Brand New Three Bedroom Ranch Home In A Quiet Community
- Spacious Family Room Includes A Clean And Efficient Gas Fireplace
- Cathedral Ceiling In The Family Room
- Wood Deck With Stairs To The Rear Yard
- Full Basement With A Walk-Out Door And Large Windows For Natural Light
- Covered Front Porch
- First Floor Laundry Room
- High Efficiency Gas Furnace and Water Heater
- Wooded Lot with Privacy
- Oversized Three Car Garage
- Approximate Total Living Space - 1640 sq. ft.
- Approximate Lower Level Living Space—1200 sq. ft. Total Finished of 2840 sq. ft.

**\$244,900**

Spille Builders and Developers is proud to be a member of  
the National Association of Home Builders since 1965!

plan 10093C



**Spille Builders and Developers Inc.**  
859-341-8268  
E-mail: tomspille@yahoo.com



Price and details subject to change.

Not part of a contract